



DEVELOPMENT SERVICES DEPARTMENT

BUILDING | COUNTYWIDE PLANNING | ENGINEERING | GIS | PLANNING & ZONING

SPECIAL EVENT PERMIT

2019-01

All fees have been paid in full as required by this permit. This special event permit shall expire and be null and void at the conclusion of the event, if any conditions herein are breached, or if the permit is transferred to any other person, corporation, organization, or entity.

EVENT INFORMATION

Event Name: **Ragnar Relay Wasatch Back**

Event Date(s): **14 June 2019**

Applicant: Liz Davidson

Event Type: Running Relay

Phone: 801-390-6890

Promoting Entity: Ragnar Events, LLC

Email: liz@ragnarrelay.com

15 MAY 2019

Approved by: Land Use Authority

Date

CONDITIONS OF APPROVAL

1. All participants and volunteers shall comply with County Ordinance §8.40 governing special events.
2. Event organizers must comply with the information as submitted in the Special Event application.
3. All participants shall be instructed to obey all traffic laws, specifically as regards riding no more than two abreast and yielding to emergency vehicles.
4. All participants shall allow access to the Fire District to the wild land area in the event of a wildland fire. Also allow access for emergency vehicles as required.
5. Must have a Mass Gathering Permit from Bear River Health Department.

AGREEMENT OF ACCEPTANCE

As the applicant for the special event described above, I hereby agree to comply with all Federal, State, and County laws, ordinances, and regulations before, during and after the event. I further agree to indemnify and save harmless Cache County, its officers, agents, and employees from and against any and all claims resulting from the use of the premises by the Applicant, the Applicant's invitees, licensees, agents and employees. I agree to permit law enforcement personnel the free and unrestricted access to and upon the premises at all times during the event for all lawful and proper purposes not inconsistent with the intent of the permit.

I understand and agree that this permit may be revoked upon breach of any of the conditions herein or at the discretion of the authorized officer. I understand that this permit is not transferable and agree not to transfer my permit to any person, corporation, organization or other entity, and is only valid within the unincorporated county.

In Accordance with Title 8 Section 8.40 of the Cache County Ordinance, I hereby submit and certify that the above information provided is accurate and complete to the best of my knowledge.

Elizabeth Davidson

6/5/19

Accepted by: Applicant

Date



CACHE COUNTY SHERIFF'S OFFICE

D. CHAD JENSEN, SHERIFF

Matt Bilodeau, Chief Deputy

Brian Locke, Lieutenant

Doyle Peck, Lieutenant

Mike Peterson, Lieutenant

EMPATHY

FAIRNESS

INTEGRITY

PROFESSIONALISM

RESPECT

RESPONSIBILITY

TRUSTWORTHINESS

To: Cache County

From: Sgt. Greg Johnson

Date: May 7, 2019

Re: RAGNAR

The Cache County Sheriff's Office has reviewed the event request for "RAGNAR 2019" and it has been determined that the Sheriff's Office will staff this event scheduled for June 14, 2019. Public Safety will be handled by the Cache County Sheriff's Office as listed in the application submitted by the event sponsor. The Utah Highway Patrol should be responsible for traffic control for any leg(s) of the race that occurs on state roads. The permit can be granted as far as the Sheriff's Office is concerned.

Sincerely,

A handwritten signature in black ink, appearing to be "G. Johnson", written over a horizontal line.

Sgt. Greg Johnson

Permits Office
Utah Department of Transportation
Region 1
Ogden, Utah

Dear UDOT Permits Division

05/05/19

I have reviewed Ragnar Wasatch Back plans for the 2019 Ragnar Wasatch Back relay in Cache Valley. I see they have some law enforcement that they intend to use in some locations however. I still have concerns over the runners cross over at Hollow Road onto SR-101 without law enforcement support or assistance. I believe if UDOT allows the closing and usage of one lane on the northbound lanes or the requirement to have runners stay on sidewalk parallel to SR-165 from Millville to Hyrum we may not need an officer in that area. They also need to follow appropriate traffic control laws for crossing Sr-165 at Mtn Crest High. Lastly they need to emphasize safety with the support vehicles and not allow improper parking or lane travel.

If the Ragnar event follows any direction provided by UDOT concerning traffic control and the runners, support vehicles and volunteers adhere to State Law we would support their permit but we will be monitoring this event closely because of past complaints.

If you or anyone else has questions regarding this matter please feel free to contact me.



Lt. Lee Perry
UHP, Section 1 Commander
20 West 700 North
Brigham City, Utah 84302
435-723-1094
435-720-3029

Laurie Jones - Re: SEP

From: "J. Downs" <downs.jay@gmail.com>
To: Laurie Jones <Laurie.Jones@cachecounty.org>
Date: 5/9/2019 3:38 PM
Subject: Re: SEP

Yea they should be good to go, different than last year.

Jay

***** IMPORTANT MESSAGE *****

This message, including any attachments, may contain confidential information intended for a specific individual and purpose, and is protected by law. If you are not the intended recipient, delete this message, including from trash, and notify me by telephone or email.

If you are not the intended recipient, any distribution or copying of this message, or the taking of any action based on its content is strictly prohibited.

On Thu, May 9, 2019 at 10:39 AM Jay Downs <Jay.Downs@cachecounty.org> wrote:

Hi Jay,
I have yet to see a response for you regarding the Ragnar Special Event. Please send your review asap.
Thanks,

Laurie Jones
Permit Technician
Cache County Development Services
[435.755.1640](tel:435.755.1640)

Laurie Jones - Re: Special Events

From: Heidi Flansberg <hflansberg@brhd.org>
To: Laurie Jones <Laurie.Jones@cachecounty.org>
Date: 4/30/2019 6:14 PM
Subject: Re: Special Events

Laurie,

Both Ragnar and Little Red Riding Hood have applied for, been approved for, and paid for their required mass gathering permits.

Please let me know if you have any questions.

Sincerely,

Heidi Flansberg Johnson, LEHS
Bear River Health Department
817 West 950 South
Brigham City, Utah 84302
435-695-2061 office
435-723-6747 fax
hflansberg@brhd.org

On Mon, Apr 29, 2019 at 12:40 PM Laurie Jones <Laurie.Jones@cachecounty.org> wrote:

Good Morning,
Please do your appropriate department review for the following and send your responses back asap.
Ragnar Special Event to be held June 14th.
Little Red Riding Hood to be held June 1st.
Thanks,

Laurie Jones
Permit Technician
Cache County Development Services
435.755.1640



CACHE COUNTY FIRE DISTRICT

179 NORTH MAIN, SUITE 309
LOGAN, UT 84321
TEL: (435) 755-1670
FAX: (435) 755-1994

To: Laurie Jones
From: Jason Winn
Date: April 30, 2019
Subject: Special Events

I have reviewed the special event applications for the Little Red Riding Hood and the Cache Grand Fondo. The main concern for the Fire District is the amount of bicycle traffic on the county roads. In the past, bike rides of this size have completely blocked an entire lane of traffic and cyclists fail to yield to emergency vehicles. Please advise the event organizers to recognize traffic safety and the requirement to yield to emergency vehicles.

I have reviewed the special events applications for the 16 Crossing Tail Run, Logan Peak Trail Run and Ragnar. The only Fire District issue is access to the wildland area in the event of a wildland fire. Event organizers and runners need to allow access for emergency vehicles as required.

From: Jared Roos <jared.roos@cachecounty.org>
To: Laurie.Jones@cachecounty.org
Date: 5/2/2019 2:42 PM
Subject: Special Event Ragnar Relay Wasatch Back.

After talking to Joel Merritt at road department they won't have anything that will effect this event.

Sent from my iPad

Laurie Jones - Re: SEP Ragnar

From: Paul Berntson
To: Laurie Jones
Date: 5/13/2019 9:50 AM
Subject: Re: SEP Ragnar

Hope they have fun! No concerns here.
PB

>>> Laurie Jones 5/9/2019 10:30 AM >>>

Hi Paul,
I have yet to see your response for Ragnar, please send asap.
Thanks,

Laurie Jones
Permit Technician
Cache County Development Services
[435.755.1640](tel:435.755.1640)



DEVELOPMENT SERVICES DEPARTMENT

BUILDING | SURVEYING | ENGINEERING | GIS | PLANNING & ZONING | ROADS | WEEDS

APPLICATION: SPECIAL EVENT PERMIT

2019-001

Date Received:	By:	Receipt #:	Check #:	Amount:
12/13/18	L JONES	#12109	37302	\$75.00

EVENT INFORMATION

Event: Ragnar Relay Wasatch Back Type: Overnight running relay race

Dates with starting/ending times: Friday, June 14, 2019 5 AM - 7 PM

AGENT/CONTACT INFORMATION

Agent/Contact: Liz Davidson Email: wb.permits@ragnarrelay.com

Phone: 801-390-6890 Mailing Address: 12 S 400 W, Suite 200, Salt Lake City, UT 84101

Name of Promoting Entity: Ragnar Events, LLC

ACKNOWLEDGMENT

In accordance with Title 8 Section 8.40 of the Cache County Ordinance, I hereby submit and certify that the information contained in this application is accurate and complete to the best of my knowledge.

Elizabeth Davidson
Applicant

10/1/18
Date

Application Deadline: Completed application forms must be submitted to the Cache County Development Services Office forty-five (45) calendar days before an event is scheduled to take place. This allows sufficient time for evaluation of the application. Late applications shall be denied unless the applicant demonstrates that compliance with the 45 day deadline was impractical or impossible due to the nature of the event. A special event permit application may be approved and a permit issued to the applicant by the Director upon approval by all the agencies specified in Section 8.40.40.

Authority: Cache County has no authority to approve permits for events other than in the unincorporated area of Cache County. Permits issued by Cache County apply only to the unincorporated area of the county, and if an event crosses into a municipality within Cache County or across the county line, applicants should determine if a permit is necessary in the other jurisdiction.

Right to Deny: Cache County reserves the right to deny permit applications for proposed special events which may pose, or have posed a significant danger or threat to the public health, welfare or safety, or which may result in unreasonable inconvenience or cost to the public. In the event the application is denied, the applicant may appeal to the Cache County Executive.

APPLICATION CHECKLIST

A complete application must include the following unless specified otherwise:

- 1) Completed application form and application fee (\$75 – no refunds) submitted 45 days prior to event. Additional fees for services provided by the Sheriff's Office, emergency services, or others may apply.
- 2) Proposed location, including a plat or map of the proposed area to be used, including any barricade, street route plans or perimeter/security fencing.
- 3) Total number of participants: Estimate must include event staff, participants, and spectators.
- 4) Public health plans, including plans for culinary water supplies, solid waste collections and disposal, and waste water (toilet facilities).
- 5) Proof of insurance in conformance with the County Ordinance 8.40.050(F) minimums: \$1,000,000 each occurrence, \$2,000,000 general aggregate, and \$100,000 property damage.
- 6) Fire prevention and emergency medical services plans.
- 7) Security plans and/or law enforcement response.
- 8) Admission fee, donation, or other consideration to be charged or requested.
- 9) Plans for parking.
- 10) *If* the event will be held on private property, a current taxation certification for that property.
- 11) Further information may be required by staff, other departments and agencies, and/or the Board/Committee/Council that reviews the application based on the proposed event.

PROJECT REVIEW PROCESS

- The applicant is encouraged to meet with staff prior to the deadline date to discuss the project and ensure that the information submitted is sufficient to provide a complete review of the project.
 - After the application is accepted, information packets are sent to various departments, agencies, and affected municipalities that provide comments and/or approval for the proposed event to the Director of Development Services.
 - In some instances a pre-event meeting may be held with planning staff and representatives from the departments and agencies that provide comments on the project review. Any issues present on a project will be discussed with the appropriate department or agency.
 - A draft permit is made available to the reviewing agencies, affected municipalities, staff, and the applicant.
 - Following agency/department review and approval, and correction of any outstanding concerns/issues, the permit can be issued.
-

October 1, 2018

RE – Special Event Additional Information- Reebok Ragnar Relay Wasatch Back 2019

Dear Cache County,

Attached, please find information on the Ragnar Relay Wasatch Back 2019 event. This document is to serve as additional information.

Included information:

- A. Event Description
- B. Date and Hours of Event
- C. Exchange Points
- D. Safety, Emergencies and First Aid
- E. Officer services
- F. Traffic Impact/ Traffic Control
- G. Waste Receptacles
- H. Signage Plan

We believe in providing a quality event that is safe and fun for participants and all involved. I look forward to working with you on this year's event.

Please contact me regarding any questions you may have.

Best Regards,

Liz Davidson | Permit Director

Ragnar Events, LLC

12 South 400 West | 2nd Floor

Salt Lake City, UT 84101

T 877 83-RELAY | F 801 499 5023 | C 801 390 6890

co.permits@ragnarrelay.com | www.runragnar.com

Will Strauss | Race Director

Ragnar Events LLC

12 South 400 West | 2nd Floor

Salt Lake City, UT 84101

O 877.837.3529 ext 141 | F 801.499.5023

will@ragnarrelay.com | www.runragnar.com

A. Event Description

The Reebok Ragnar Relay Wasatch Back is a long distance running relay race that will start in Logan, UT on Friday, June 14, 2019 and finish in Kamas, UT on Saturday, June 15, 2019.

- We anticipate 450 teams to participate in the event. Each team is comprised of 6-12 individuals and 1-2 vehicles. Therefore, we anticipate about 5,300 participants and 900 vehicles to be involved in the race.
- During the relay, each team member runs three legs. Only one person from each team will be running on the course at a time. **There will only be 450 runners on the course at any given time.**
- Start times are staggered, beginning at 5:00 AM and will continue until 1:00 PM. The objective for the staggered start time is to spread the participants out so that the impact on local traffic will be minimal to avoid large groups of runners clustering together.
- The entire group of runners will typically be spread out over a span of 30-40 miles.
- Runners are instructed to obey all traffic laws and regulations. The race course will utilize sidewalks, running paths, bike lanes, and road shoulders.
- We do not foresee a need to close any lanes of traffic or close any running paths to pedestrians or bike traffic.

B. Date and hours of the event:

Jun 14, 2019

We anticipate runners in Cache County from 5:00 AM until 7:00 PM.

C. Exchange Points

Teams pass the baton from one runner to the next at minor and major exchange points. An exchange includes portable toilets, an exchange area, and traffic cones used for crowd control. A minor exchange is where a single van from each team will briefly stop to switch runners. There are 30 minor exchanges along the course. A major exchange occurs every 6 exchanges and is where teams will pass the baton to the next van. There are 5 major exchanges along the course.

Ragnar is in the process of obtaining permission from the various locations for the use of exchanges.

Exchange Points in Cache County:

- Exchange 1: LDS Church – 800 S 600 E, River Heights, UT
- Exchange 2: LDS Church – 600 S 200 E, Hyrum, UT 84319
- Exchange 3: LDS Church - LDS Church -155 E 9400 S, Paradise, UT 84328
- Exchange 4: Val Kotter's Field
- Exchange 5: Avon Pass

D. Safety, Emergencies, and First Aid

Safety is our top priority. Runners are educated prior to the race concerning event and safety rules as follows:

- Each team must have at least six reflective vests and two flashlights. Runners starting their legs during designated night hours must be wearing a reflective vest, tail/butt light and holding a flashlight or headlamp.
- Any team-member spectator must wear a reflective vest during these hours when outside their vehicle.
- Runners are required to obey all traffic laws and we instruct them to use the sidewalk when available.
- Ragnar provides a Race Command number during the race. Runners may text Race Command for any concerns or problems out on the course.
- In case of emergency all runners and staff will call 911. Then contact our Race Command number (661-Ragnar1) to let race staff know of the emergency.
- We have 8-12 Ragnar Staff and trained volunteers on the course at all times monitoring the course.
- A Medic Station and Medical Staff will be located at each major exchange location. These Medic Stations will be equipped to handle heat exhaustion, and all minor sport injuries. We hire EMT intermediate personnel or above, either through a medical staffing agency or directly through local hospitals or emergency service personnel.
- In the event of a major medical emergency (i.e. any life threatening condition or injury that requires immediate medical attention) we instruct runners/volunteers to first call 911.
- In addition to our own first aid services on the course, we list the local emergency rooms near the course, along with their address and phone number in our race app.

E. Officer services

Police Officers are stationed throughout the course in specific locations according to the safety demand and traffic flow throughout their jurisdiction. Ragnar will work with Cache County Sheriff's Office to determine officer needs.

F. Traffic impact/ traffic control

All traffic control measures are to be set up, maintained and removed by Utah Barricade Co. Ragnar will work with Cache County Traffic Department to determine safety needs.

G. Waste receptacles

Dumpsters will be placed at each of our major exchange locations. All trash is taken to the majors. Volunteers and staff will sweep in exchange and make sure they are left clean.

H. Signage plan

Along the course there will be course signs that communicate to the runners which direction to go, on what side of the road to run, which exchange they are at, etc. Directional signs are only placed at change of direction intersections. The signs are 42" High, 18" Wide, .25" Thick and are made of corrugated plastic. Each sign will be secured to a delineator post barricade. An example of such a sign can be seen in the picture below.

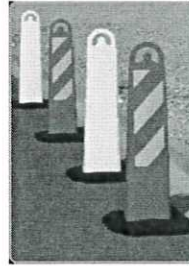

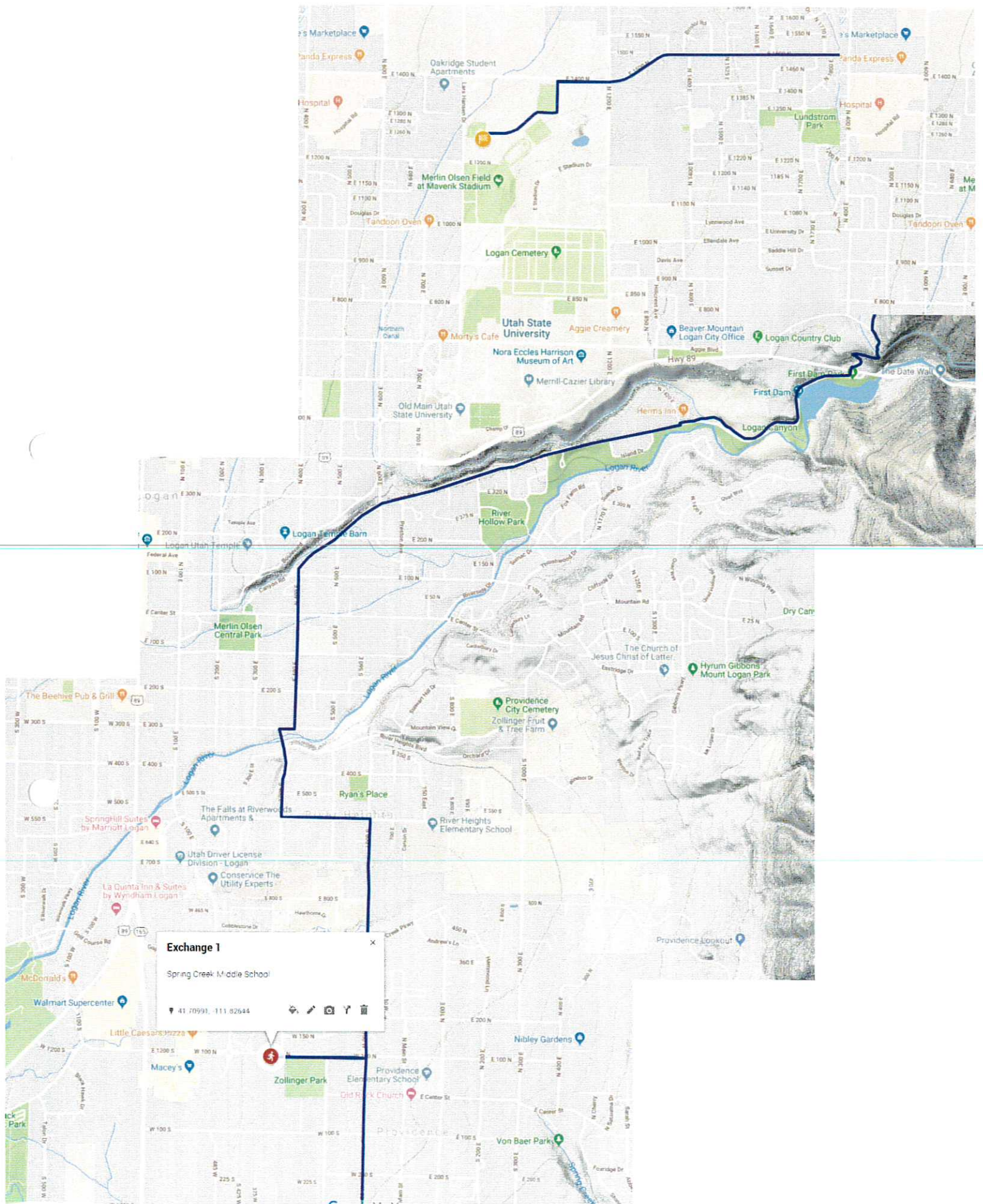

Exchange 1

Spring Creek Middle School

41.70991, -111.82644

Navigation icons: location pin, home, search, print, zoom in, zoom out, refresh, close.

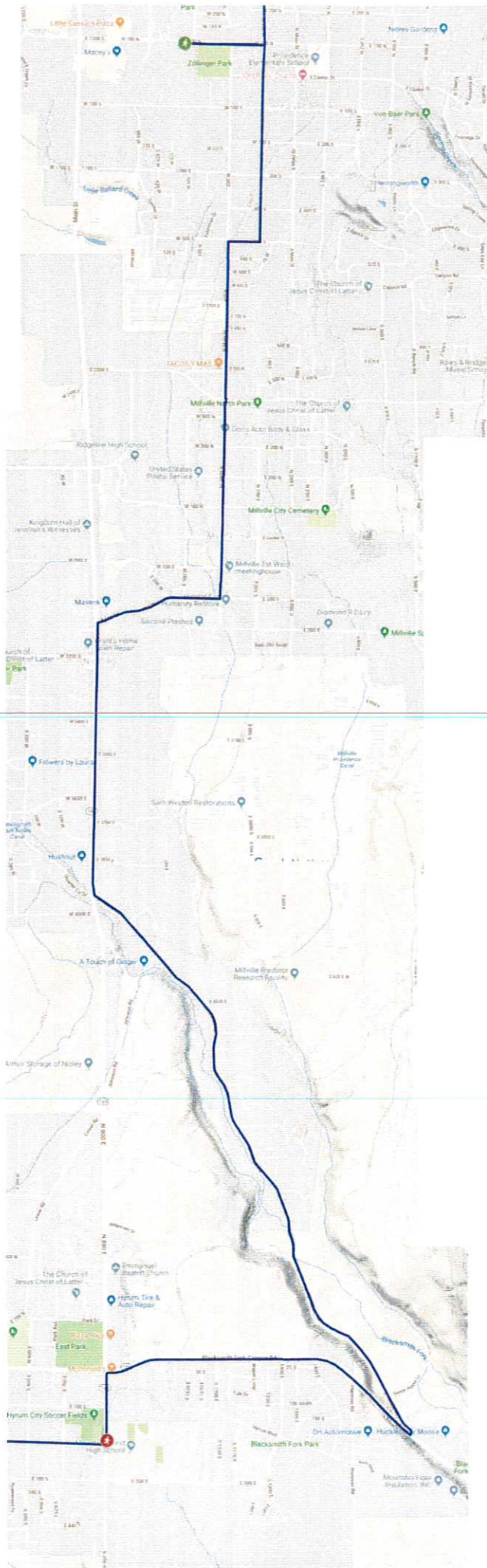

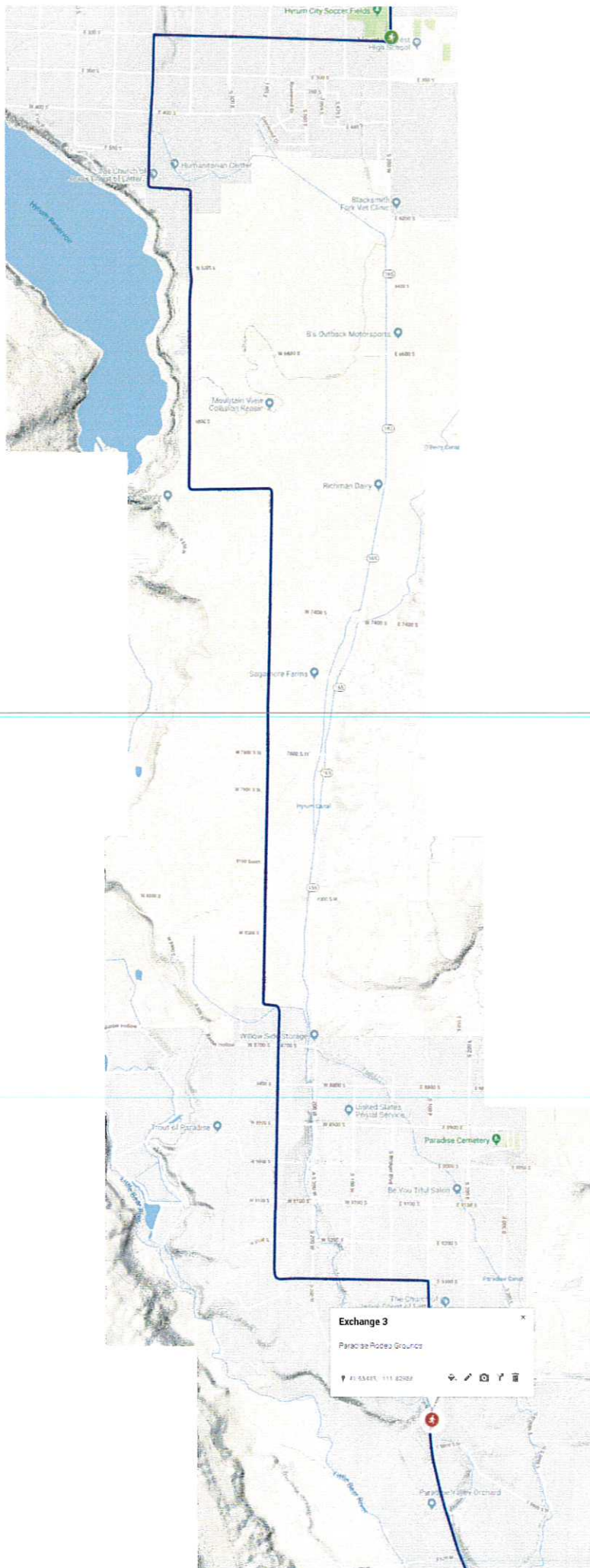

Exchange 3

Paradise Pools Grounds

11 53:00 111 8200

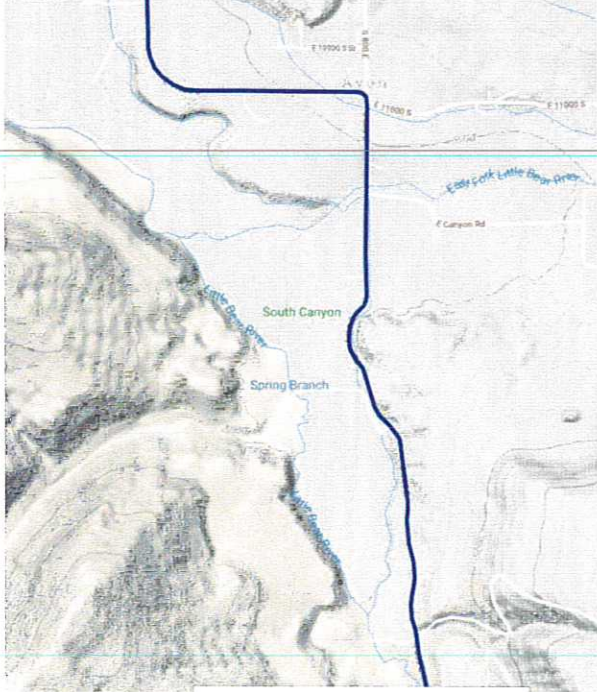



Wasatch Back 2019

Friday, June 14, 2019

Cache County



TABLE OF CONTENTS

1. Traffic Control Measures
2. Event Timeline
3. Police Officer Plan
4. Medical Officer Plan
5. Emergency Plan
6. Signage Plan
7. Race Command



Traffic Control Measures:

There will be no road closures within Cache County. All runners will be on sidewalks or shoulders throughout Cache County. Team vans will drive directly to the permitted exchange locations listed on route maps.

To ensure vans do not pull over

Ragnar will implement the following plan to enforce the non-support rule within Cache County

1. Leg maps will list all legs within Cache County as a Non-Support legs.
2. Teams will be notified in Race Bible, Team Captains Meeting, race day Safety Briefings, and push notifications on the Ragnar App.
3. Race Day- prior to teams entering Cache County, Ragnar Race Command will send out reminder text messages to all teams of critical non-support areas.
4. Staff will patrol the route and issue violations to any teams disobeying rules.

EVENT TIMELINE

Timeline in Cache County						
Exchange	Set Up	First Runner Arrival Time	Peak Vans At Exchange	Peak Time	Last Runner Departure Time	Tear Down
1	4:00 AM	5:30 AM	71	5:54 AM	3:15 PM	3:30 PM
2	5:00 AM	6:47 AM	79	7:17 AM	4:12 PM	4:30 PM
3	6:00 AM	7:37 AM	52	8:34 AM	4:48 PM	5:00 PM
4	7:30 AM	8:25 AM	48	9:20 AM	5:24 PM	6:00 PM
5	8:00 AM	10:03 AM	85	11:05 AM	7:06 PM	7:30 PM

Proposed Police Locations- Cache County

Ragnar will work with Cache County Police Department and to solidify number of police officers and locations on the route.

RAGNAR RELAY WASATCH BACK - CACHE COUNTY - POLICE OFFICER LIST					
#	LOCATION		JURISDICTION	Date	Time
1	Start	USU Parking Area - 1200 North & 800 East in Logan	USU Officers	2-Jun	3:00 AM - 4:00 PM
1	Leg 1	Intersection of 1200 E and 14000 N Logan	Logan City Police	2-Jun	4:00 AM - 5:00 PM
1	Leg 1	Intersection of 1500 North and 1600 East in Logan	Logan City Police	2-Jun	4:00 AM - 5:00 PM
1	Leg 2	100 North & 100 West in Providence	Cache County Police	2-Jun	6:00 AM - 6:00 PM
1	Leg 4	Floating Officer on SR-162 (Avon Pass Road) at Road Closure, Avon	Cache County Police	2-Jun	8:00 AM - 7:00 PM



1	na	Floating Motor Officers within Cache County	Cache County Police	2-Jun	
---	----	---	---------------------	-------	--

Medical Officer Plan

RAGNAR RELAY WASATCH BACK - SUMMIT COUNTY - MEDIC LIST					
#	Ex/Leg	LOCATION	JURISDICTION	Date	Time
2	Start	USU	EMSS/Ragnar	3-Jun	4:00 AM – 1:00 PM

EMERGENCY RESPONSE PLAN

RUNNER & STAFF COMMUNICATION

The Ragnar Relay Wasatch Back will follow the same internal communication plan followed at dozens of other Ragnar events nationwide.

The Race Director for the Ragnar Relay Wasatch Back is Will Strauss. His phone number is 801-318-1097. Assisting him along the course will be dozens of other staff members.

In addition, we have our ‘Race Command’ phone number – 661-Ragnar1. This phone number is given to all runners at their safety briefing at the Start Line and in the Ragnar App. At any point during the race if a runner or team needs assistance they can contact this number. Race Command can then contact Will, the Race Director, or any other nearby staff to resolve any issue. In addition, Race Command is equipped to get in touch with any local police or emergency services as necessary. This Race Command has proved very effective in assisting runners, lending support, and helping to manage the race.

Beyond that, we have an Exchange Manager designated for each exchange along the course who is in continual contact with the Ragnar Staff and Race Command. The Exchange Manager is responsible for managing volunteers stationed along the route.

Volunteers are local citizens that are familiar with the area and are trained by the Volunteer Trainer (staff) and the Exchange Manager. Each team is required to provide 3 volunteers to participate in the race. Each volunteer is given a packet of information outlining their responsibilities and what to do in the event of an emergency. Each volunteer station will be equipped with cell phones and a full list of phone numbers for the Race Directors, Race Command, Ragnar Staff and emergency personnel. Should a need arise they will be able to get in touch with the appropriate person to help resolve the problem.

In addition the Race Director/Assistant Race Directors, Exchange Managers, and Volunteers, there will be at least 7 other Ragnar Staff Members acting as Safety Marshalls. These staff members are ‘floaters’ and drive along the course to ensure it is running smoothly and resolving any issues that may arise and watching out for the general safety of the runners.

Anytime a team needs to get in direct contact with Ragnar Staff or the Race Director, all they have to do is talk to a volunteer or call Race Command. Each Team is also given a list of local hospitals should they need that information.



All Ragnar Staff members will be wearing shirts that clearly show that they are 'STAFF' members. Exchange Managers also will wear these shirts. Volunteers are given hats that indicate that they are the 'Race Crew'. Each hat is bright colored in nature as to stand out and clearly identify who is working for Ragnar.

SAFETY/FIRST AID/MEDICAL INFORMATION

Safety:

We require every runner to attend a short Safety Briefing before they are allowed to run in the race.

This is a requirement and not a suggestion. Each team is required to check in, show all their safety gear for running at night (headlamps, LED flashing rear lights, and enough reflective vests for the entire team), and listen to the 10 minute review of all the safety rules. These rules are placed in a prominent location of the Ragnar App. Here is a brief outline of the items discussed at the Safety Briefing:

- Disqualification Policy
- Items to keep Runners Safe
- Items to keep Runners Support Safe
- Items to keep the Relay overall Safe
- Instruction on running on appropriate surfaces (i.e. against traffic, on shoulders)
- Instructions on what to do if a runner is lost
- Rules for Night Running – No one is allowed to leave an exchange at night without their functioning gear on
- Reminder to Hydrate
- Rules for giving support at night – ALL team members must wear reflective vests during official night hours
- Use of Crossing flags
- Non-Support Leg rules
- Being safe at the Exchange Locations
- No Alcohol during the race
- Race Command – 661-Ragnar1
- Call 911 in an Emergency

Emergency Contact:

In the event of a major medical emergency, we instruct runners/volunteers to first call 911. This is covered in a safety briefing that each team takes part in at the start of the race. The line of communication then follows: 911 then Race Director, then most Senior Ragnar Staff Member on the course then Course Manager for that section.

First Aid Locations, Equipment and Certification:

We have first aid staff available at every major exchange along the course (Exchanges 6, 12, 18, 24, 30) and the Finish Line. Generally, major exchanges are separated by 25-35 miles. The first aid stations are equipped to handle the minor sport injuries we often experience, including blisters, sprains, strains, stings, etc.

We utilize volunteers for first aid locations with appropriate and up to date certification. We hire first aid workers through a medical staffing agency or directly through local hospitals or emergency service personnel.



Medical Information:

In addition to our own first aid services on the course, we list the local hospitals near the course, along with their address and phone number in our 'Race Bible' where possible.

EMERGENCY PROCEDURES

General Staff Emergency Procedures

- a. Always consider your personal safety during emergency situations.
- b. Do not risk injury or inclusion in an emergency event.
- c. Remain calm.
- d. Alert Race Command of all serious emergency situations.
 - RAGNAR RACE COMMAND phone number: 661-RAGNAR1
 - Call code for serious emergency situations: CODE 13
 - Call code for non-emergency situations: CODE 4
- e. Assess situation thoroughly before taking action.
- f. Do not perform rescue actions or medical procedures unless you have proper training.
- g. Consider the safety of the public while assessing the situation.
- h. Report all dangerous, suspicious or hazardous situations to your supervisor immediately.
- i. If unsure of correct course of action, call 911 immediately.
- j. Do not initiate an evacuation without authorization from Race Command or the Incident Commander.
- k. Direct all arriving Police, Fire or First Response Agencies to incident or Race Command. Alert Race Command in all cases.
- l. Following an emergency event, fill out an Incident Report.

1. Animal Nuisance

- a. Alert EMS, Fire Department or Police on site.
- b. If unable to locate first response agencies, call 911.
- c. Do not attempt to apprehend animal.
- d. Alert nearby patrons of danger.

2. Auto Collision/Heavy Equipment Accident

- a. Call 911.
- b. If safe, cordon off affected area.

3. Bomb Threat

- a. Treat all bomb threats as credible.



- b. DO NOT SEARCH OR ATTEMPT TO DISMANTLE A BOMB OR SUSPICIOUS OBJECT.
- c. Cease all radio and electronic communications transmissions.
- d. If threat by note, try not to handle. Call 911.
- e. If by call, probe for more information. Collect as much information as possible including:

- i. Name:

- ii. Phone number:

- iii. Location of device:

- iv. Type of device:

- v. Time of call:

- vi. Caller Demographics: (Circle all that apply)

- 1. MALE FEMALE MULTIPLE CALLERS

- 2. AGE JUVENILE ADULT

- 3. OTHER:

- vii. Background Noise:

- viii. Emotional State: (Circle all that apply)

- 1. ANGRY PANIC FEAR

- 2. LAUGHING HAPPY INDIFFERENT

- 3. HURRIED CALM NORMAL

- 4. OTHER:

- ix. Caller demands, message or rationale:

- 1. DEMAND:

- 2. MESSAGE:

- 3. REASON FOR THREAT:

- x. Who would caller like to speak with:

- 1. Speak with:

- 2. Call back number:

- f. Attempt to keep caller on the phone as long as possible.

- g. Call 911 as soon as possible.

- h. Do not alert others of threat unless instructed to do so by Race Command or the Incident Commander.

4. Chemical Spill/Toxic Hazard

- a. If possible, determine chemical spill and obtain Material Safety Data Sheet.

- b. If safe, cordon off affected area.



- c. If safe, use Chemical Spill Kit to clean up spill.
- d. If spill determined to be unsafe, call 911.
- e. Contact Race Command to alert of unsafe situation. Evacuation will be considered.
- f. All event activities will be suspended until threat level decreases.
- g. If necessary, follow EVACUATION procedures.

5. Civil Disturbance

- a. Call 911.
- b. All event activities will be suspended until threat level decreases.
- c. If necessary, follow EVACUATION procedures.
- d. If external disturbance, consider shelter in place.
- e. Monitor but do not lock emergency exits.

6. Criminal Activity

- a. Alert Police on site or call 911.
- b. Do not intervene.

7. Disorderly Conduct

- a. Alert Police on site or call 911.
- b. Do not intervene.

8. Earthquake

- a. All activities will be suspended until threat level decreases.
- b. Staff to assess current venue safety. Report hazards to Race Command.
- c. If safe, cordon off affected areas.
- d. If necessary, set up simple triage and medical response area. Maintain secure perimeter and access control. Restrict to staff and injured only.
- e. Do not affect evacuation unless situation dictates.
- f. Do not attempt collapse rescue unless trained to do so.
- g. All staff to return to command zone for briefing and emergency post assignments and supply distribution.
- h. Institute ICS if required.
- i. If necessary, follow EVACUATION procedures.

9. Electrical Storm

- a. All activities will be suspended until threat level decreases.
- b. Staff to prepare for evacuation. Preferred refuge at indoor facility.
- c. Prepare indoor of alternate facilities for evacuation prior to initiation.
- d. If necessary, follow EVACUATION procedures.



10. Evacuation

Do not cause an evacuation without prior authorization from Race Command or the Incident Commander.

All evacuation procedures should be followed unless time and situation dictate otherwise.

- a. If an evacuation is considered, confer with emergency response agencies on site.
- b. Institute ICS operations if evacuation is agreed upon.
- c. Stand by until Incident Command, staff and security personnel are in place and ready to safely execute an evacuation.
- d. Ensure the evacuation routes, intended areas of refuge or shuttle systems are safe and prepared prior to initiating evacuation.
- e. Position staff to assist patrons with evacuation.
- f. Secure parking lot entrance and exits. Prevent all public traffic from entering the site unless otherwise instructed.
- g. If necessary, stage shuttle buses prior to initiating evacuation.
- h. Calmly alert patrons of evacuation and location or direction to evacuate to.
- i. Staff to perform a final venue sweep to ensure facility is clear.
- j. If safe, position staff to prevent patrons from re-entering evacuated area.
- k. Continue to monitor safety of area of refuge. Initiate evacuation scenario above if necessary to move.

11. Fire

- a. If safe, trained staff should extinguish small fires with fire extinguishers.
- b. If fire determined to large to be safely extinguished, call 911.
- c. If safe, staff should cordon off area affected.
- d. All event activities will be suspended until threat level decreases.
- e. If necessary, follow EVACUATION procedures.

12. Flood:

- a. All festival activities will be suspended until threat level decreases.
- b. Alert Artists of closure.
- c. All event activities will be suspended until threat level decreases.
- d. If necessary, follow EVACUATION procedures.

13. High Winds:

- a. Identify potential hazards and report to Race Command.
- b. Deflate inflatable structures as safety dictates.
- c. Secure all potential hazards.



- d. All event activities will be suspended until threat level decreases.
- e. If necessary, follow EVACUATION procedures.

14. Medical Emergency

- a. Alert EMS, Fire Department or Police on site.
- b. If unable to locate first response agencies, call 911.
- c. Provide support and assistance as necessary.
- d. Do not perform rescue or provide medical assistance unless trained to do so.

15. Power Outage

- a. Event to continue unless determined otherwise.
- b. Music program suspended.
- c. Food service requiring electricity suspended.
- d. If threat level increases, all event activities will be suspended.
- e. If necessary, follow EVACUATION procedures.

16. Rain/downpour:

- a. Event continues unless threat level increases.
- b. If threat level increases, all event activities will be suspended.
- c. If necessary, follow EVACUATION procedures.

17. Structural Collapse

- a. Call 911.
- b. Do not attempt rescue operations unless safe.
- c. If safe, staff should cordon off area affected.
- d. All event activities will be suspended until threat level decreases.
- e. If necessary, follow EVACUATION procedures.

18. Suspicious Object

- a. DO NOT TOUCH OR MOVE A SUSPICIOUS OBJECT, DEVICE OR PACKAGE.
- b. DO NOT SEARCH OR ATTEMPT TO DISMANTLE A BOMB OR SUSPICIOUS OBJECT.
- c. Cease all radio and electronic communications transmissions.
- d. Notify Race Command or nearby police.
- e. If safe, cordon off the immediate area.
- f. If threat level increases, all event activities will be suspended.
- g. If necessary, follow EVACUATION procedures.

19. Other Emergencies

- a. Assess the situation.



- b. If determined serious, call 911.
- c. Otherwise, follow logical course of action.

Emergency Numbers

Emergency Agencies	911
Ragnar Race Command	661-RAGNAR1
Cache County Police Department	435-755-1000
Bear River Health Dept	435-792-6500
Logan Animal Control	435-753-7555

Ragnar Contact Information

Ragnar Race Command	Ragnar Race Command	661-RAGNAR1
Will Strauss	Race Director	801-318-1097
Chris Infurchia	CEO	203-317-7747



SIGNAGE

Along the course we propose placing signs that communicate to the runners which direction to go. Our Blue Ragnar signs will be placed on orange traffic delineators. The signs are 42" High, 18" Wide, 0.25" Thick and are made of corrugated plastic. Below is an example of the signage.

Signage will be placed at each location where the runners would need to turn. Signs will be placed on a traffic delineator or cone.

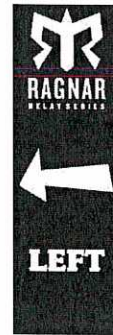

Race Command

Race Command is a system that allows Ragnar to manage the race and communicate directly with runners in real-time. Race Command allows Ragnar to:

- Enforce rules and regulations
- Immediately disqualify teams
- Communicate directly with teams in emergency situations
- Notify teams of last minute course changes
- Deliver targeted messages to teams designed to effect their behavior
- Send out friendly reminders to Teams to obey rules, be safe and be respectful of the communities they are passing through.

Prior to the event teams are given an official race packet customized specifically for the race. The race packet is an important part of the race as it includes:

- Race Course maps
- Safety Information
- Important Race information
- Ragnar App
- Race Command contact numbers
- Etc, etc.

The Race Command phone number **661-Ragnar1** is an extremely important number for Teams. It is the primary method for Teams to communicate back to Ragnar during the race. This number is also printed in the RagMag, which is distributed to each team at the start line. Teams are encouraged to contact Race Command for the following reasons:

- To report other teams that may be breaking rules
- To communicate emergency situations to Ragnar
- To ask questions regarding the race, vehicles and spectators
- To notify Ragnar of any course problems

During the event Race Command consists of 2 Ragnar employees who are generally stationed at the Ragnar offices in Salt Lake City, UT. These employees monitor all messages they receive from participants and act on those messages through our multi-faceted communication network including mass-text, phone, radio and email communications.



Additionally, during the event Ragnar has 10-20 staff members along the course that are monitoring teams for rule violations, emergency situations, etc. Staff members contact race command and report these violations/situations immediately.

Race Command implements a three strikes policy. After three rule violations Race Command notifies the team they have been disqualified and instructs Ragnar staff members to confiscate the teams baton and escort them off the course. Ragnar reserves the right to immediately disqualify teams for any reason.

Community Hotline

Again this year, Ragnar will also monitor a Community Hotline **(503) 37-RELAY**. The Community Hotline will be distributed through all community outreach channels. The intention of this hotline is to reroute resident concerns from the County and Sheriff's office to Ragnar so that Ragnar can address those concerns immediately. Ragnar will share these communications with the appropriate agencies. Please note, all life-threatening emergency situations are to be handled directly through 911.

CERTIFICATE OF INSURANCE

PRINT DATE: 4/18/2019

CERTIFICATE NUMBER: 20190418695810

AGENCY:

Integro USA Inc.
d/b/a Integro Insurance Brokers
2727 Paces Ferry Road, Building Two, Suite 1500
Atlanta, GA 30339
678-324-3300 (Phone), 678-324-3303 (Fax)

THIS CERTIFICATE IS ISSUED AS A MATTER OF INFORMATION ONLY AND CONFERS NO RIGHTS UPON THE CERTIFICATE HOLDER. THIS CERTIFICATE DOES NOT AMEND, EXTEND OR ALTER THE COVERAGE AFFORDED BY THE POLICIES BELOW.

NAMED INSURED:

USA Track & Field, Inc. 130 East Washington Street, Suite 800 Indianapolis IN 46204	Ragnar Events, LLC 12 South 400 West, 2nd Floor Salt Lake City UT 84101
---	---

INSURERS AFFORDING COVERAGE:

INSURER A: Philadelphia Indemnity Ins. Co. NAIC #: 18058
INSURER B: Philadelphia Indemnity Ins. Co. NAIC #: 18058

EVENT INFORMATION:

Wasatch Back Ragnar Relay (6/14/2019 - 6/15/2019)

POLICY/COVERAGE INFORMATION:

THE POLICIES OF INSURANCE LISTED BELOW HAVE BEEN ISSUED TO THE INSURED NAMED ABOVE FOR THE POLICY PERIOD INDICATED. NOTWITHSTANDING ANY REQUIREMENT, TERM OR CONDITION OF ANY CONTRACT OR OTHER DOCUMENT WITH RESPECT TO WHICH THIS CERTIFICATE MAY BE ISSUED OR MAY PERTAIN, THE INSURANCE AFFORDED BY THE POLICIES DESCRIBED HEREIN IS SUBJECT TO ALL THE TERMS, EXCLUSIONS AND CONDITIONS OF SUCH POLICIES. AGGREGATE LIMITS SHOWN MAY HAVE BEEN REDUCED BY PAID CLAIMS.

INS	TYPE OF INSURANCE:	POLICY NUMBER(S):	EFFECTIVE:	EXPIRES:	LIMITS:
A	GENERAL LIABILITY				
	<input checked="" type="checkbox"/> Occurrence	PHPK1899025	11/1/2018 12:01 AM	11/1/2019 12:01 AM	GENERAL AGGREGATE (Applies Per Event) \$3,000,000
	<input checked="" type="checkbox"/> Participant Legal Liability				EACH OCCURRENCE \$1,000,000
					DAMAGE TO RENTED PREMISES (Each Occ.) \$1,000,000
					MEDICAL EXPENSE (Any one person) EXCLUDED
					PERSONAL & ADV INJURY \$1,000,000
					PRODUCTS-COMP/OP AGG \$3,000,000
B	UMBRELLA/EXCESS LIABILITY				
	<input checked="" type="checkbox"/> Occurrence	PHUB652176	11/1/2018 12:01 AM	11/1/2019 12:01 AM	EACH OCCURRENCE \$10,000,000
					AGGREGATE (Applies Per Event) \$10,000,000

DESCRIPTION OF OPERATIONS/LOCATIONS/VEHICLES/EXCLUSIONS ADDED BY ENDORSEMENT/SPECIAL PROVISIONS:

Coverage applies to USA Track & Field sanctioned events and registered practices, including any directly related activities, such as event set-up and tear-down, participant check-in and award ceremonies.

The certificate holder is an additional insured per the following endorsement: Additional Insured - Certificate Holders (Form PI-AM-002)

The General Liability policy is primary and non-contributory with respect to the negligence of the Named Insureds (Form CG 00 01)

The General Liability policy contains a blanket Waiver of Subrogation as required by contract per Waiver of Transfer of Rights of Recovery Against Others (Form CG 24 04).

Excess policy follows form of underlying General Liability.

CERTIFICATE HOLDER:

Cache County Corporation
199 North Main
Logan UT 84321

NOTICE OF CANCELLATION:

Should any of the above described policies be cancelled before the expiration date thereof, notice will be delivered in accordance with the policy provisions.

AUTHORIZED REPRESENTATIVE:



CERTIFICATE OF INSURANCE

PRINT DATE: 5/2/2019

CERTIFICATE NUMBER: 20190502697709

AGENCY:

Integro USA Inc.
 d/b/a Integro Insurance Brokers
 2727 Paces Ferry Road, Building Two, Suite 1500
 Atlanta, GA 30339
 678-324-3300 (Phone), 678-324-3303 (Fax)

THIS CERTIFICATE IS ISSUED AS A MATTER OF INFORMATION ONLY AND CONFERS NO RIGHTS UPON THE CERTIFICATE HOLDER. THIS CERTIFICATE DOES NOT AMEND, EXTEND OR ALTER THE COVERAGE AFFORDED BY THE POLICIES BELOW.

NAMED INSURED:

USA Track & Field, Inc. Ragnar Events LLC
 130 East Washington Street, Suite 800
 Indianapolis IN 46204

INSURERS AFFORDING COVERAGE:

INSURER A: Philadelphia Indemnity Ins. Co. NAIC #: 18058
 INSURER B: Philadelphia Indemnity Ins. Co. NAIC #: 18058

EVENT INFORMATION:

Ragnar Relay Wasatch Back 2019 (6/14/2019 - 6/15/2019)

POLICY/COVERAGE INFORMATION:

THE POLICIES OF INSURANCE LISTED BELOW HAVE BEEN ISSUED TO THE INSURED NAMED ABOVE FOR THE POLICY PERIOD INDICATED. NOTWITHSTANDING ANY REQUIREMENT, TERM OR CONDITION OF ANY CONTRACT OR OTHER DOCUMENT WITH RESPECT TO WHICH THIS CERTIFICATE MAY BE ISSUED OR MAY PERTAIN, THE INSURANCE AFFORDED BY THE POLICIES DESCRIBED HEREIN IS SUBJECT TO ALL THE TERMS, EXCLUSIONS AND CONDITIONS OF SUCH POLICIES. AGGREGATE LIMITS SHOWN MAY HAVE BEEN REDUCED BY PAID CLAIMS.

INS	TYPE OF INSURANCE:	POLICY NUMBER(S):	EFFECTIVE:	EXPIRES:	LIMITS:
A	GENERAL LIABILITY				
	<input checked="" type="checkbox"/> Occurrence	PHPK1899025	11/1/2018 12:01 AM	11/1/2019 12:01 AM	GENERAL AGGREGATE (Applies Per Event) \$3,000,000
	<input checked="" type="checkbox"/> Participant Legal Liability				EACH OCCURRENCE \$1,000,000
					DAMAGE TO RENTED PREMISES (Each Occ.) \$1,000,000
					MEDICAL EXPENSE (Any one person) EXCLUDED
					PERSONAL & ADV INJURY \$1,000,000
					PRODUCTS-COMP/OP AGG \$3,000,000
B	UMBRELLA/EXCESS LIABILITY				
	<input checked="" type="checkbox"/> Occurrence	PHUB652176	11/1/2018 12:01 AM	11/1/2019 12:01 AM	EACH OCCURRENCE \$10,000,000
					AGGREGATE (Applies Per Event) \$10,000,000

DESCRIPTION OF OPERATIONS/LOCATIONS/VEHICLES/EXCLUSIONS ADDED BY ENDORSEMENT/SPECIAL PROVISIONS:

Coverage applies to USA Track & Field sanctioned events and registered practices, including any directly related activities, such as event set-up and tear-down, participant check-in and award ceremonies.

The certificate holder is an additional insured per the following endorsement: Additional Insured - Certificate Holders (Form PI-AM-002)

The General Liability policy is primary and non-contributory with respect to the negligence of the Named Insureds (Form CG 00 01)

The General Liability policy contains a blanket Waiver of Subrogation as required by contract per Waiver of Transfer of Rights of Recovery Against Others (Form CG 24 04).

Excess policy follows form of underlying General Liability.

CERTIFICATE HOLDER:

City of Providence
 164 N Gateway Dr.
 Providence UT 84332

NOTICE OF CANCELLATION:

Should any of the above described policies be cancelled before the expiration date thereof, notice will be delivered in accordance with the policy provisions.

AUTHORIZED REPRESENTATIVE:

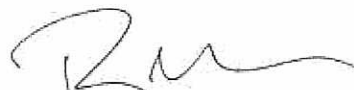

CERTIFICATE OF INSURANCE

PRINT DATE: 11/7/2018

CERTIFICATE NUMBER: 20181107665855

AGENCY:

Integro USA Inc.
d/b/a Integro Insurance Brokers
2727 Paces Ferry Road, Building Two, Suite 1500
Atlanta, GA 30339
678-324-3300 (Phone), 678-324-3303 (Fax)

THIS CERTIFICATE IS ISSUED AS A MATTER OF INFORMATION ONLY AND CONFERS NO RIGHTS UPON THE CERTIFICATE HOLDER. THIS CERTIFICATE DOES NOT AMEND, EXTEND OR ALTER THE COVERAGE AFFORDED BY THE POLICIES BELOW.

NAMED INSURED:

USA Track & Field, Inc. Ragnar Events, LLC
130 East Washington Street, Suite 800 12 South 400 West, 2nd Floor
Indianapolis IN 46204 Salt Lake City UT 84101

INSURERS AFFORDING COVERAGE:

INSURER A: Philadelphia Indemnity Ins. Co. NAIC #: 18058
INSURER B: Philadelphia Indemnity Ins. Co. NAIC #: 18058

EVENT INFORMATION:

Ragnar Relay Wasatch Back 2019 (6/14/2019 - 6/15/2019)

POLICY/COVERAGE INFORMATION:

THE POLICIES OF INSURANCE LISTED BELOW HAVE BEEN ISSUED TO THE INSURED NAMED ABOVE FOR THE POLICY PERIOD INDICATED. NOTWITHSTANDING ANY REQUIREMENT, TERM OR CONDITION OF ANY CONTRACT OR OTHER DOCUMENT WITH RESPECT TO WHICH THIS CERTIFICATE MAY BE ISSUED OR MAY PERTAIN, THE INSURANCE AFFORDED BY THE POLICIES DESCRIBED HEREIN IS SUBJECT TO ALL THE TERMS, EXCLUSIONS AND CONDITIONS OF SUCH POLICIES. AGGREGATE LIMITS SHOWN MAY HAVE BEEN REDUCED BY PAID CLAIMS.

INS	TYPE OF INSURANCE:	POLICY NUMBER(S):	EFFECTIVE:	EXPIRES:	LIMITS:
A	GENERAL LIABILITY				
	<input checked="" type="checkbox"/> Occurrence	PHPK1899025	11/1/2018 12:01 AM	11/1/2019 12:01 AM	GENERAL AGGREGATE (Applies Per Event) \$3,000,000
	<input checked="" type="checkbox"/> Participant Legal Liability				EACH OCCURRENCE \$1,000,000
					DAMAGE TO RENTED PREMISES (Each Occ.) \$1,000,000
					MEDICAL EXPENSE (Any one person) EXCLUDED
					PERSONAL & ADV INJURY \$1,000,000
					PRODUCTS-COMP/OP AGG \$3,000,000
B	UMBRELLA/EXCESS LIABILITY				
	<input checked="" type="checkbox"/> Occurrence	PHUB652176	11/1/2018 12:01 AM	11/1/2019 12:01 AM	EACH OCCURRENCE \$10,000,000
					AGGREGATE (Applies Per Event) \$10,000,000

DESCRIPTION OF OPERATIONS/LOCATIONS/VEHICLES/EXCLUSIONS ADDED BY ENDORSEMENT/SPECIAL PROVISIONS:

Coverage applies to USA Track & Field sanctioned events and registered practices, including any directly related activities, such as event set-up and tear-down, participant check-in and award ceremonies.

The certificate holder is an additional insured per the following endorsement: Additional Insured - Certificate Holders (Form PI-AM-002)

The General Liability policy is primary and non-contributory with respect to the negligence of the Named Insureds (Form CG 00 01)

The General Liability policy contains a blanket Waiver of Subrogation as required by contract per Waiver of Transfer of Rights of Recovery Against Others (Form CG 24 04).

Excess policy follows form of underlying General Liability.

CERTIFICATE HOLDER:

City of Logan and Cache County
290 N 100 W
Logan UT 84321

NOTICE OF CANCELLATION:

Should any of the above described policies be cancelled before the expiration date thereof, notice will be delivered in accordance with the policy provisions.

AUTHORIZED REPRESENTATIVE:



Philadelphia Indemnity Insurance Company

A.M. Best #: 003616 NAIC #: 18058 FEIN #: 231738402

Domiciliary Address

One Bala Plaza Suite 100
Bala Cynwyd, PA 19004-1403
United States

Web: www.phly.com

Phone: 610-617-7900

Fax: 610-617-7940

Financial Strength Rating

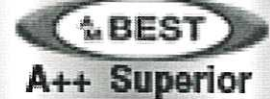

Assigned to insurance companies that have, in our opinion, a superior ability to meet their ongoing insurance obligations.

[View additional news, reports and products for this company.](#)

Based on A.M. Best's analysis, 058633 - Tokio Marine Holdings, Inc. is the **AMB Ultimate Parent** and identifies the topmost entity of the corporate structure. [View a list of operating insurance entities in this structure.](#)

Best's Credit Ratings

Financial Strength Rating [View Definition](#)

Rating: A++ (Superior)
Affiliation Code: p (Pooled)
Financial Size Category: XV (\$2 Billion or greater)
Outlook: Stable
Action: Affirmed
Effective Date: December 21, 2018
Initial Rating Date: June 30, 1981

Long-Term Issuer Credit Rating [View Definition](#)

Long-Term: aa+
Outlook: Stable

Action: Affirmed
Effective Date: December 21, 2018
Initial Rating Date: June 03, 2005

u Denotes Under Review Best's Rating

Best's Credit Rating Analyst

Rating Office: A.M. Best Rating Services, Inc.

Financial Analyst: Samiksha Gupta

Associate Director : Robert Raber

Note: See the Disclosure information Form or Press Release below for the office and analyst at the time of the rating event.

Disclosure Information

Disclosure Information Form

View A.M. Best's Rating Disclosure Form

Press Release

AM Best Affirms Credit Ratings of Philadelphia Insurance Companies' Members
December 21, 2018

Rating History

A.M. Best has provided ratings & analysis on this company since 1981.

Financial Strength Rating

Effective Date Rating

12/21/2018	A++
12/1/2017	A++
9/21/2016	A++
6/4/2015	A++
5/8/2014	A++

Long-Term Issuer Credit Rating